

NUNEATON AND BEDWORTH BOROUGH COUNCIL

**THE NUNEATON AND BEDWORTH BOROUGH COUNCIL (CAMP HILL PHASE 3 - QUEEN
ELIZABETH ROAD, HAZEL ROAD, LUDFORD ROAD, SPRING HILL ROAD AND ROWAN
ROAD) COMPULSORY PURCHASE ORDER 2010**

GENERAL VESTING DECLARATION (No. 5)

Ref: RF02/505678.07012

Pinsent Masons LLP

3 Colmore Circus

Birmingham

B4 6BH

Solicitors to Nuneaton and Bedworth Borough Council

THIS GENERAL VESTING DECLARATION is made the 15th day of October 2012 by the Nuneaton and Bedworth Borough Council ("the Authority").

WHEREAS:

- (1) On 1 April 2010 an order entitled the Nuneaton and Bedworth Borough Council (Camp Hill Phase 3 - Queen Elizabeth Road, Hazel Road, Ludford Road, Spring Hill Road and Rowan Road) Compulsory Purchase Order 2010 was confirmed by the Secretary of State for Communities and Local Government under the powers conferred on him by the Town and Country Planning Act 1990 authorising the Authority to acquire the land specified in the Schedule hereto.
- (2) Notice of the confirmation of the order was first published in accordance with section 15 of the Acquisition of Land Act 1981 on 22 April 2010.
- (3) That notice included the particulars specified in section 3(3) of the Compulsory Purchase (Vesting Declarations) Act 1981 ("the Act").
- (4) The notice referred to in (3) above specified the period of 2 months beginning with the date of its first publication as the period before the end of which this general vesting declaration could not be executed.

NOW THIS DEED WITNESSETH that, in exercise of the powers conferred on them by section 4 of the Act, the Authority hereby declare:-

1. The land described in the Schedule hereto (being part of the land authorised to be acquired by the order) and more particularly delineated and shown coloured pink on the plan annexed hereto, together with the right to enter upon and take possession of the land, shall vest in the Authority as from the end of the period of 28 days from the date on which the service of notices required by section 6 of the Act is completed.
2. For the purposes of Section 2(2) of the Act, the specified period in relation to the land comprised in this declaration is one year and one day.

	Hazel Road, except interests owned by the highway authority. (Part of plot only).
13	All interests in approximately 80.9 square metres of highway land comprising the half width of the northern side of the public highway known as Queen Elizabeth Road and the half width of the southern side of the public highway known as Hazel Road, except interests owned by the highway authority. (Part of plot only).
16	All interests in approximately 82 square metres of highway land comprising the half width of the northern side of the public highway known as Queen Elizabeth Road and the half width of the southern side of the public highway known as Hazel Road, except interests owned by the highway authority.
17	All interests in approximately 76.9 square metres of highway land comprising the half width of the northern side of the public highway known as Queen Elizabeth Road and the half width of the southern side of the public highway known as Hazel Road, except interests owned by the highway authority. (Part of plot only).
18	All interests in approximately 106.9 square metres of highway land comprising the half width of the northern side of the public highway known as Queen Elizabeth Road and the half width of the southern side of the public highway known as Hazel Road, except interests owned by the highway authority. (Part of plot only).
21	All interests in approximately 76.3 square metres of highway land comprising the half width of the northern side of the public highway known as Queen Elizabeth Road and the half width of the southern side of the public highway known as Hazel Road, except interests owned by the highway authority. (Part of plot only).
23	All interests in approximately 833.4 square metres of land comprising the half width of the southern side of the public highway known as Queen Elizabeth Road located to the south of 279-305 Queen Elizabeth Road, part of full width of the public highway known as Queen Elizabeth Road situated to the south of grassland located to the west of 273 Queen Elizabeth Road, part of the full width of the public highway known as Queen Elizabeth Road situated to the south of grassland located to the west of 305 Queen Elizabeth Road and the half widths of the eastern and southern sides of the public highway known as Hazel Road situated to the east and north of grassland located to the west of 305 Queen Elizabeth Road, except interests owned by the acquiring authority and highway authority.
27	All interests in approximately 67.1 square metres of highway land comprising the half width of the northern side of the public highway known as Hazel Road and the half width of the southern side of the public highway known as Ludford Road, except interests owned by the highway authority. (Part of plot only)
28	All interests in approximately 76.8 square metres of highway land comprising the half width of the northern side of the public highway known as Hazel Road and the half width of the southern side of the public highway known as Ludford Road, except interests owned by the highway authority. (Part of plot only)
29	All interests in approximately 128.9 square metres of highway land comprising the half width of the northern side of the public highway known as Hazel Road and the half width of the southern side of the public highway known as Ludford Road, except interests owned by the acquiring authority and the highway authority. (Part of plot only).
30	All interests in approximately 79.4 square metres of highway land comprising the half width of the northern side of the public highway known as Hazel Road and the half width of the southern side of the public highway known as Ludford Road,

49	All interests in approximately 58.1 square metres of highway land comprising the half width of the northern side of the public highway known as Ludford Road and the half width of the southern side of the public highway known as Spring Hill Road, except interests owned by the highway authority. (Part of plot only).
50	All interests in approximately 56.7 square metres of highway land comprising the half width of the northern side of the public highway known as Ludford Road and the half width of the southern side of the public highway known as Spring Hill Road, except interests owned by the highway authority. (Part of plot only).
51	All interests in approximately 55.5 square metres of highway land comprising the half width of the northern side of the public highway known as Ludford Road and the half width of the southern side of the public highway known as Spring Hill Road, except interests owned by the highway authority. (Part of plot only).
52	All interests in approximately 35.4 square metres of highway land comprising the half width of the northern side of the public highway known as Ludford Road and the half width of the southern side of the public highway known as Spring Hill Road, except interests owned by the highway authority. (Part of plot only).
53	All interests in approximately 36.8 square metres of highway land comprising the half width of the northern side of the public highway known as Ludford Road and the half width of the southern side of the public highway known as Spring Hill Road, except interests owned by the highway authority. (Part of plot only).
54	All interests in approximately 31.6 square metres of highway land comprising the half width of the northern side of the public highway known as Ludford Road and the half width of the southern side of the public highway known as Spring Hill Road, except interests owned by the highway authority. (Part of plot only).
56	All interests in approximately 64.4 square metres of highway land comprising the half width of the northern side of the public highway known as Ludford Road and the half width of the southern side of the public highways known as Spring Hill Road and Edinburgh Road, except interests owned by the highway authority. (Part of plot only).
57	All interests in approximately 39.7 square metres of highway land comprising the half width of the northern side of the public highway known as Ludford Road, except interests owned by the highway authority. (Part of plot only).
58	All interests in approximately 35.4 square metres of highway land comprising the half width of the northern side of the public highway known as Ludford Road, except interests owned by the highway authority. (Part of plot only).
59	All interests in approximately 31.1 square metres of highway land comprising the half width of the northern side of the public highway known as Ludford Road, except interests owned by the highway authority. (Part of plot only).
61	All interests in approximately 51.8 square metres of highway land comprising the half width of the southern side of the public highway known as Spring Hill Road, except interests owned by the highway authority. (Part of plot only).

References to plot numbers above are references to plot numbers on the map referred to in the Nuneaton and Bedworth Borough Council (Camp Hill Phase 3 - Queen Elizabeth Road, Hazel Road, Ludford Road, Spring Hill Road and Rowan Road) Compulsory Purchase Order 2010 – General Vesting Declaration (No. 5).

THE COMMON SEAL of THE)
NUNEATON AND BEDWORTH)
BOROUGH COUNCIL was)
hereunto affixed in the presence of:)

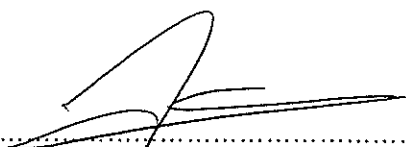
.....
Authorised Signatory

Dated this 15th day of October 2012

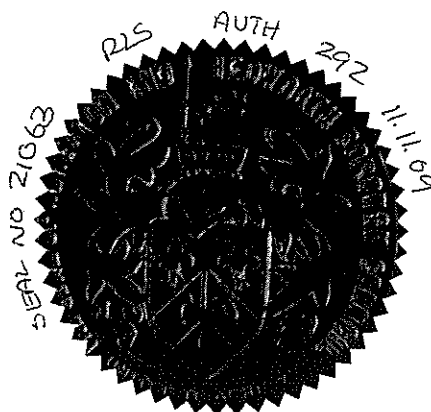

Map referred to in the Nuneaton and Bedworth Borough Council (Camp Hill Phase 3 - Queen Elizabeth Road, Hazel Road, Ludford Road, Spring Hill Road and Rowan Road) Compulsory Purchase Order 2010 - General Vesting Declaration (No.5)

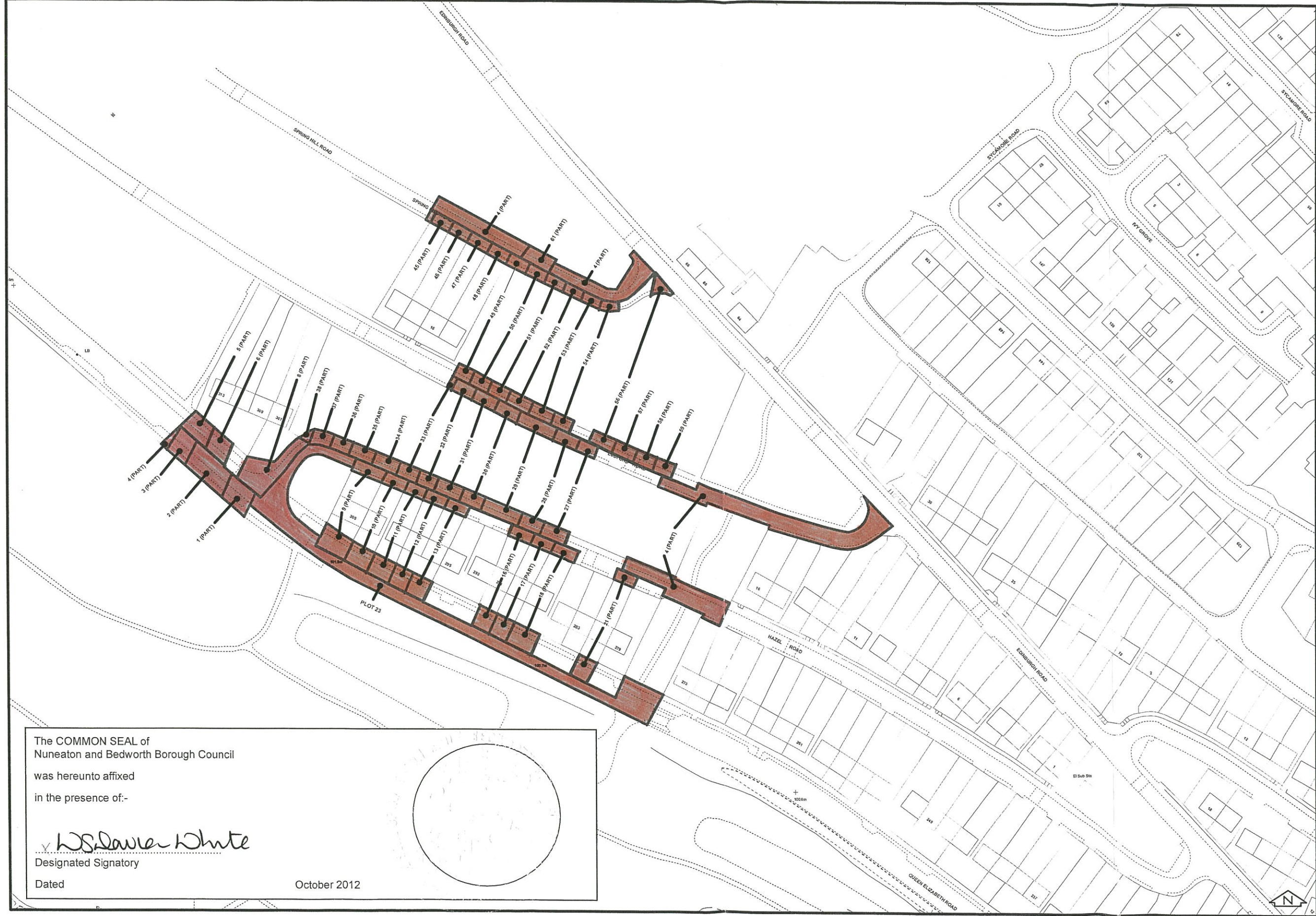

The COMMON SEAL of
Nuneaton and Bedworth Borough Council
was hereunto affixed
in the presence of:-

W. S. Davies White
Designated Signatory
Dated
October 2012

Produced by:
Nuneaton & Bedworth
United to Achieve

Nuneaton and Bedworth
Borough Council.
Town Hall,
Coton Road,
Nuneaton,
Warwickshire
CV11 5AA

Land to be acquired

Drawn By: RS
Date Drawn: 01/10/2012
Checked By: CE
Checked Date: 01/10/2012
Approved By: RF
Approved Date: 01/10/2012

Title:
Map referred to in
the Nuneaton and
Bedworth Borough
Council (Camp Hill
Phase 3 - Queen
Elizabeth Road,
Hazel Road,
Ludford Road,
Spring Hill Road
and Rowan Road)
Compulsory Pur-
chase Order 2010 -
General Vesting
Declaration (No.5)